



The Catholic Cemeteries of the Diocese of Joliet

Pre-need Services

At-need Services

Memorial Products



***Do you not realize that your body is a temple of the Holy Spirit
who is in you and whom you received from God? (1 Cor. 6:19)***



“No one thinks of winter when the grass is green” Rudyard Kipling

Planning ahead of your burial will bring immediate peace of mind and financial security to you and those you love.

One of the greatest gifts you can give them is the freedom of beautiful memories over mournful reality. Making cemetery arrangements well in advance of need is a family matter. It is, after all, the family who will be impacted both emotionally and financially by a death.

The biggest hurdle is getting the family to plan together. Your children are no doubt anxious for reassurance from you that everything has been taken care of, but they are understandably timid about approaching you about this sensitive matter.

Providing leadership by speaking frankly to your family about the importance of preplanning is the best path to success.

The initial decisions in preplanning are so personal; they can only be made by you. What kind of memorial do you wish to prepare? Choosing a beautiful and well-managed cemetery that's close to family is paramount. It is also important to ensure that the cemetery offer options that coincide with your wishes. For example, if you desire an upright headstone, you should inquire if this is permitted.



After selecting the cemetery you desire, you must decide on the method of burial. Traditionally, the most common is in-ground burial but the number of families choosing above-ground options is increasing dramatically. When visiting a cemetery, you will want to discuss the burial options available with a cemetery representative. Some offerings are much less expensive than most people imagine, such as mausoleum entombment.

Memorialization is also an important step in remembering the life of a loved one. A memorial helps preserve those precious memories forever.

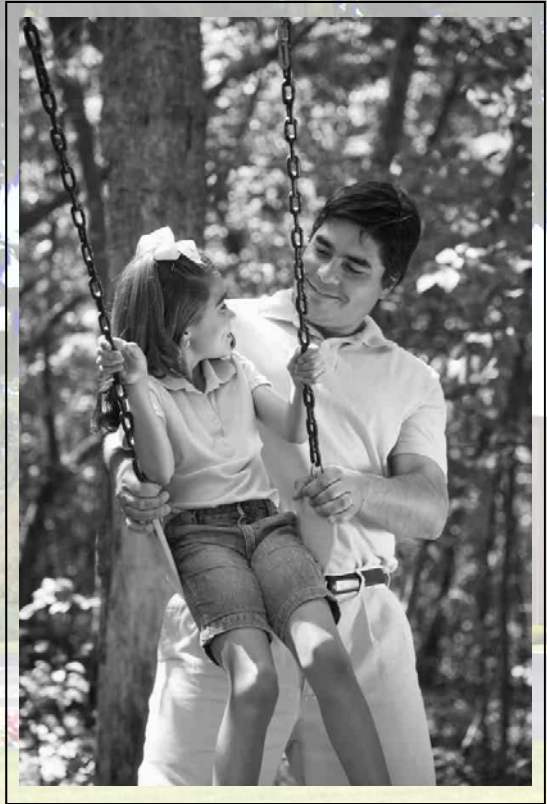

A Planned Investment. An emotionally distressed family often pays dearly for at-need arrangements that far exceed the wishes of the departed. Making your cemetery plans and paying for them well in advance will relieve your family of this burden, expense, and endless hours worrying and possibly conflicting with other family members about your burial wishes and whether they are met.

There is much to do, but plenty of time. People are taking responsibility early for preplanning. The generation of the early 1950s led the way by purchasing cemetery plots in advance of need. Their children, now in their 40s and 50s, are following suit by choosing and making complete burial plans as part of their estate planning.

There are well over fifty individual responsibilities to be completed by *someone* at the time of need. In a single meeting with one of our family service representatives, you can get one-third of these tasks accomplished.

About us. There are twenty-one Diocesan Cemeteries within the Diocese of Joliet, from the stately grounds of Assumption Cemetery in Wheaton; to the countryside of All Saints Cemetery in Bourbonnais; to our newly consecrated (2004) Risen Lord Cemetery in Oswego. Our cemeteries are rich with history, abundant with inspiring works of art, and imbued with serene natural beauty. Each cemetery has its own special features, statuary, and ambiance. The Catholic Cemeteries of the Diocese of Joliet has served the communities for over one hundred years and are staffed by professionals who are dedicated to making sure your wishes are realized at the time of need. We provide pre-need interest free burial package plans, at-need burial services, and memorialization products ranging from magnificent upright custom monuments; to elegant flush memorials. Our burial offerings include traditional in-ground burial, mausoleum entombment, cremation inurnment, and specifically designed cremation gardens.

To further assist you in prearranging your wishes, the Catholic Cemeteries of the Diocese of Joliet has compiled a preplanning workbook entitled “When the time comes: A guide to my Last Wishes”. This workbook provides focus and guidance, giving you a consolidated resource for recording personal and vital information that will be needed when a death occurs.

To receive your personal complimentary copy, please visit one of our family service centers or log on to our website at:
www.dioceseofjoliet.org/cemeteries/guidetomylastwishes.asp



SERVICES AVAILABLE AT: The Catholic Cemeteries of the Diocese of Joliet

BURIAL OFFERINGS FOR THE FULL BODY

◆ IN-GROUND BURIAL

The in-ground burial options include large family estate lots, multiple space lots, and single grave spaces. The space, depending on the size and location in the cemetery, can be memorialized with magnificent upright custom monuments to elegant flush memorials personalized with meaningful family and religious symbols that can be further enhanced with bronze plaques, statuary, vases, and other distinctive alternatives to the basic designs.

In-ground burials are available at:

- All Catholic Cemeteries of the Diocese of Joliet

◆ MAUSOLEUM ENTOMBMENT

A structure or building containing crypts specifically designed for the entombment of casketed remains. A casket is placed in a crypt within a mausoleum when it is entombed.



⇒ PRIVATE ESTATE MAUSOLEUM

Distinctively designed personal mausoleums provide exclusive above-ground entombment.

The mausoleum can be personalized by adding options such as: Urns, vases, wings and numerous other enhancements. Meaningful family and religious symbols, artistically inscribed by experienced craftsmen, make the beautiful granite mausoleum an individualized testament to a life. The mausoleum provides private, permanent security and protection from the elements. The number of entombments within the private estate mausoleum varies on the size constructed.

Private Estate Mausoleum's are available at:

- All Catholic Cemeteries of the Diocese of Joliet

⇒ COMMUNAL MAUSOLEUM

Impressive mausoleum buildings offer individual elegant crypt space for the entombment of casketed remains. These crypts are a tribute attesting to the honor and dignity of a life lived. We offer both interior and exterior communal mausoleum crypts.

Communal Mausoleum's are available at:

- All Saints Cemetery, Bourbonnais
- Assumption Cemetery, Wheaton
- Resurrection Cemetery, Romeoville
- Mt. Calvary Cemetery, Kankakee
- Mt. Olivet Cemetery, Joliet

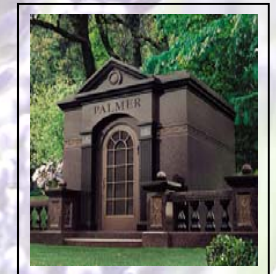

Cremation also requires a plan. It does not eliminate the need for a formal funeral, a necessary part of the grieving process for your family and friends, nor does it eliminate the need for a final resting place.

For members of the Catholic Faith the cremated remains of a body should be treated with the same respect given to the corporal remains. This includes the use of a worthy vessel for the cremated remains, the manner in which they are carried, the care and attention to appropriate placement and transport, and the final disposition. It is recommended that cremation take place after the funeral liturgy, however, the funeral liturgy may be celebrated in the presence of the cremated remains. Cremated remains of the body should be buried in a grave, entombed in a mausoleum, or inurned in a columbarium. Scattering of the cremated remains of the body is not permitted by the Catholic beliefs.



SERVICES AVAILABLE AT: The Catholic Cemeteries of the Diocese of Joliet **BURIAL OFFERINGS FOR THE CREMATED REMAINS OF THE BODY**

◆ CREMATION GARDEN

Typically, cremation gardens are specifically designed and beautifully landscaped areas in a natural setting and accommodates various expressions of memorialization. At the Catholic Cemeteries of the Diocese of Joliet, the garden provides a sanctuary for family members to honor a loved one with a memorial that features beautiful and innovative designs ranging from cored boulders, cored benches; developed with stunning statuary, pillars and bronze on granite flush memorials. These gardens provide a reverent and permanent final resting place for the cremated remains of the body.

Cremation Gardens are available at:

- **All Saints Cemetery, Bourbonnais**
- **Assumption Cemetery, Wheaton**
- **Risen Lord Cemetery, Oswego**

◆ CREMATION COLUMBARIUM

A Cremation Columbarium is a structure, room, or other space in a indoor mausoleum or an outdoor environment, or other building containing niches. The columbarium niche space is available in various size capacities and provides a dignified and permanent housing enclosure for the cremated remains of the body.

⇒ GLASS FRONT

Glass front cremation niches provides you with endless opportunity to visually personalize your niche with a decorative memorial urn, photo and other personal mementos. Personalization is not only engaging but aesthetically pleasing and uniquely reflects a life loved and lived.

Glass Fronts Niches are available at:

- All Saints Cemetery, Bourbonnais
- Assumption Cemetery, Wheaton
- Resurrection Cemetery, Romeoville

⇒ GRANITE FRONT

Granite front cremation niches are personalized with a bronze name plaque, and depending on the cemetery, an optional cameo picture portrait, and bronze bud vase for both our interior and exterior units.

Granite Front Niches are available at:

- All Saints Cemetery, Bourbonnais
- Assumption Cemetery, Wheaton
- Mt. Calvary Cemetery, Kankakee
- Resurrection Cemetery, Romeoville
- Risen Lord Cemetery, Oswego
- St. Mary Cemetery, Elmhurst

⇒ WOOD FRONT

Wood front cremation niches are personalized with a bronze name plaque and optional bronze bud vase.

Wood Front Niches available at:

- Resurrection Cemetery, Romeoville



If there were a death in your family today, would your children know what to do? Would they know your wishes?

If you have not taken care of your burial plans, and would like to discuss the burial services available to you at The Catholic Cemeteries of the Diocese of Joliet; our family service representatives can guide you through our offerings, personalizing the arrangements to meet your specific and unique needs.

You are most welcome to tour our grounds and meet our staff. We encourage you to plan ahead now to ease the emotional and financial stress later. At The Catholic Cemeteries of the Diocese of Joliet, our care and commitment to the families we serve is paramount.

Please call one of our Family Service Centers to schedule your consultation.



(Intentionally left blank)

"Come to me, all you who are weary and burdened, and I will give you rest. Take my yoke upon you and learn from me, for I am gentle and humble in heart, and you will find rest for your souls. For my yoke is easy and my burden is light." (Matthew 11:28-30)



The Catholic Cemeteries of the Diocese of Joliet

www.dioceseofjoliet.org/cemeteries



The Catholic Cemeteries
of the Diocese of Joliet

Espanol 1.815.726.7444

REGION I – DuPage County 1.630.668.3313

1. Assumption Cemetery & Mausoleum, Wheaton
2. S.S. Peter & Paul Cemetery, Naperville
3. St. Mary Cemetery & Cremation Columbarium, Elmhurst
4. St. Bernard Cemetery, Downers Grove
5. St. Mary Cemetery, Lombard
6. St. John the Baptist Cemetery, Winfield
7. St. Stephen Cemetery, Carol Stream

REGION II – Kendall County 1.630.554.7590

8. Risen Lord Cemetery, Oswego

REGION III – Will County 1.815.886.0750

9. Resurrection Cemetery & Mausoleum, Romeoville

REGION IV – Will County 1.815.726.7444

10. Mt. Olivet Cemetery & Garden Mausoleum, Joliet
11. S.S. Cyril & Methodius Cemetery, East Joliet
12. St. Patrick Cemetery, Joliet
13. St. John the Baptist Cemetery, Joliet
14. Holy Cross Cemetery, Crest Hill
15. St. Mary Nativity Cemetery, Crest Hill
16. Calvary Cemetery, Lockport
17. St. Dennis Cemetery, Lockport

REGION V – Kankakee County 1.815.933.2342

18. All Saints Cemetery & Mausoleum, Bourbonnais
19. Mt. Calvary Cemetery & Mausoleum, Kankakee
20. Maternity BVM Cemetery, Bourbonnais
21. St. Rose Cemetery, Kankakee

Overview of Cemetery Locations

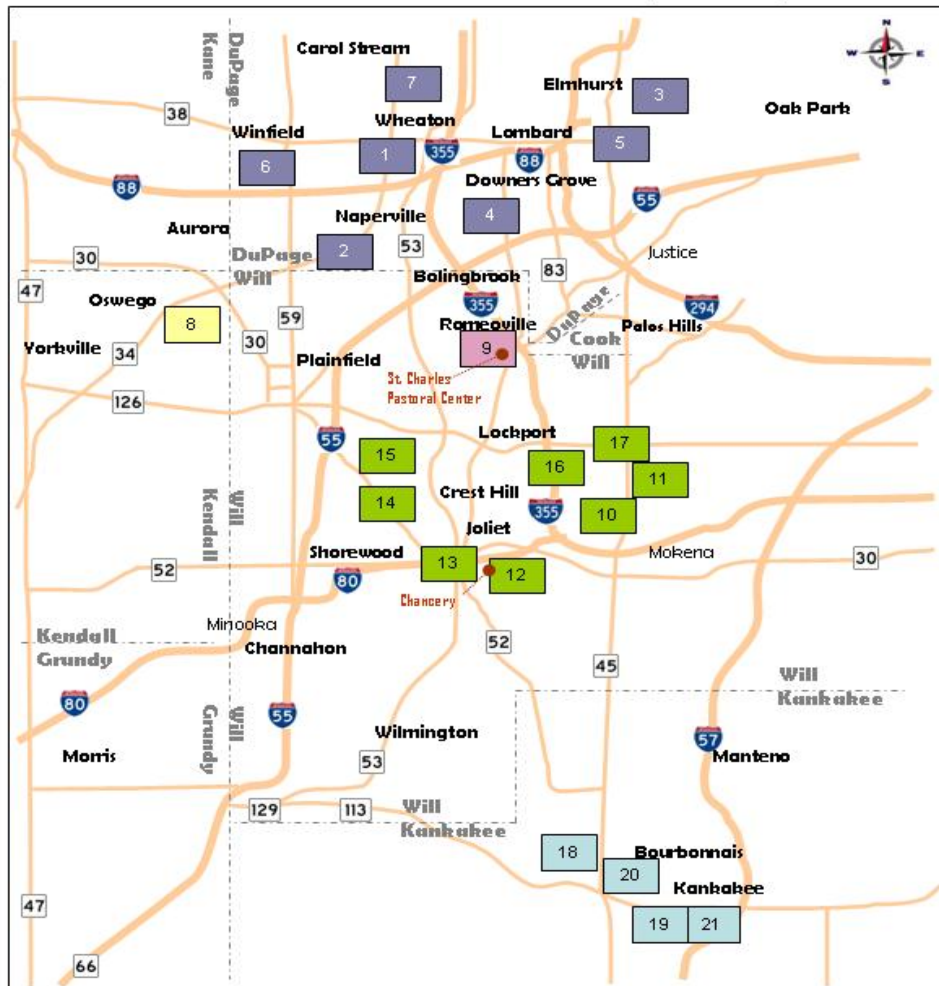



The Catholic Cemeteries of the Diocese of Joliet

Beautifully manicured grounds developed in 1962, with a family service center on-site. This stately cemetery offers a comprehensive line of burial services; Chapel Mausoleum, Communal and Private Mausoleum Entombment Crypts, In-ground burial, and Cremation options including a specifically designed Cremation Garden, Garden Niches, and indoor Mausoleum Niches for cremated remains. It is one of the few cemeteries in the area to offer a Cremation Garden and Glass Front Cremation Niches.

- *Pre-need and At-need burial services tailored to meet your family needs*
- *Chapel Mausoleum for final committal service, prayer and reflection, with lighted devotional votive stand*
- *Private or Communal Mausoleum's are entombment options*
- *Double depth lawn crypts for superior protection from the elements*
- *Mature tree lined burial grounds for in-ground burial with upright or flush memorial*
- *In-ground with upright or flush memorial, Glass Front & Granite Front Cremation Niches, and specifically designed Cremation Gardens are cremation options*
- *Special Infant Memorial garden*
- *Personalized and Custom Memorials created and designed reflecting a life loved and lived.*
- *Bench memorials available as a place to sit and reflect which can also be developed to hold the cremated remains of a loved one*
- *Vases are another form of memorialization available to hold the placement of flowers honoring a life*

Assumption Cemetery 1.630.668.3313
15510 Winfield Rd, Wheaton IL 60189

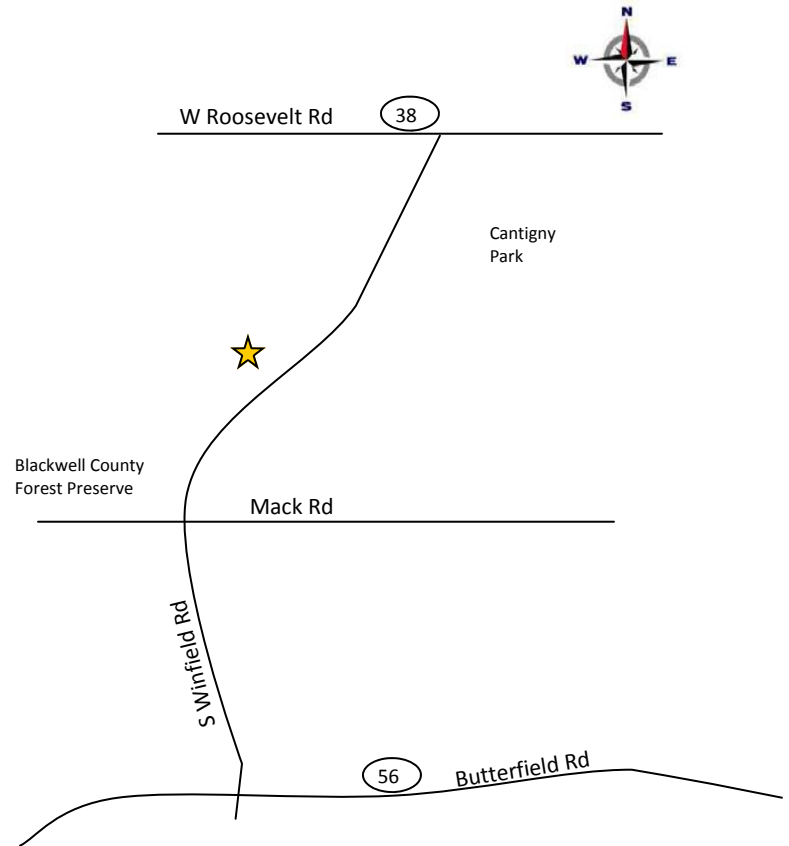

www.dioceseofjoliet.org/cemeteries

for complete details including the wide range of choices and pricing



The Catholic Cemeteries of the Diocese of Joliet

This beautiful cemetery, in the historical town of Naperville, offers a large line of burial services; Private Mausoleum Entombment Crypts, In-ground burial, and Cremation options. It has a spectacular old stone grotto and stunning statuary throughout the cemetery.

- *Pre-need and At-need burial services tailored to meet your family needs*
- *Private Mausoleum's are entombment options*
- *Mature tree lined burial grounds for in-ground burial with upright or flush memorial*
- *In-ground with upright or flush memorial are cremation options*
- *Personalized and Custom Memorials created and designed reflecting a life loved and lived.*
- *Bench memorials available as a place to sit and reflect which can also be developed to hold the cremated remains of a loved one*
- *Vases are another form of memorialization available to hold the placement of flowers honoring a life*



*Family Service Center located at:
Assumption Cemetery
1S.510 Winfield Rd
Wheaton IL 60189*

Ss. Peter & Paul Cemetery 1.630.668.3313
Columbia & North Ave, Naperville IL 60540

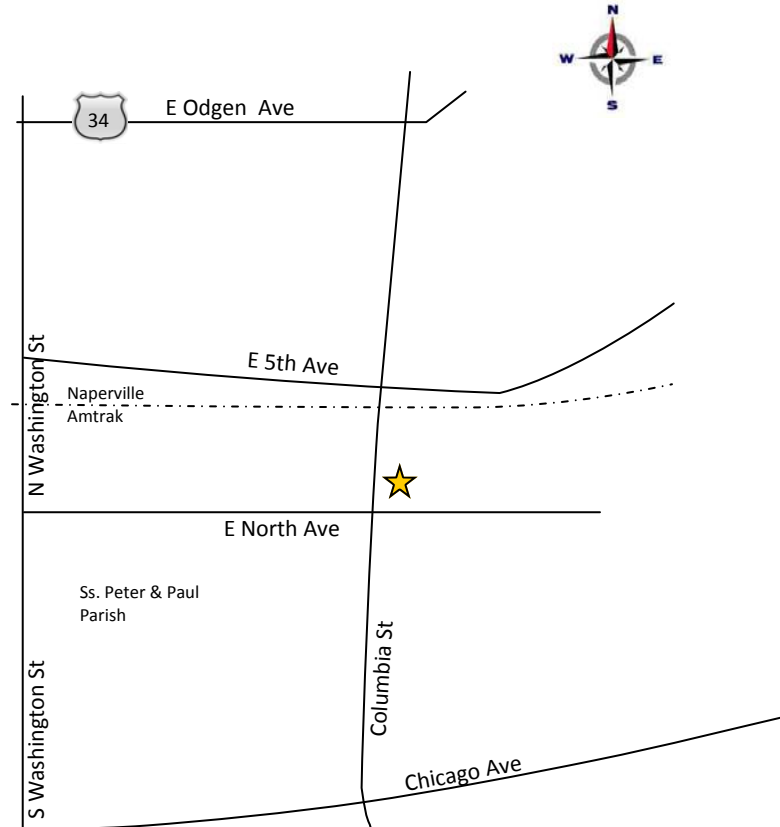

www.dioceseofjoliet.org/cemeteries

for complete details including the wide range of choices and pricing



The Catholic Cemeteries of the Diocese of Joliet

This cemetery is situated in a quite neighborhood next to Elmhurst College. It offers a large line of burial services; Private Mausoleum Entombment Crypts, In-ground burial for full body remains and cremated remains, with upright or flush memorial options, and cremation columbarium niches for the cremated remains of the body.

- *Pre-need and At-need burial services tailored to meet your family needs*
- *Private Mausoleum's are entombment options*
- *Mature tree lined burial grounds for in-ground burial with upright or flush memorial*
- *In-ground with upright or flush memorial and Exterior Cremation Columbarium Niches are cremation options*
- *Personalized and Custom Memorials created and designed reflecting a life loved and lived.*
- *Bench memorials available as a place to sit and reflect which can also be developed to hold the cremated remains of a loved one*
- *Vases are another form of memorialization available to hold the placement of flowers honoring a life*



Family Service Center located at:
Assumption Cemetery
1S.510 Winfield Rd
Wheaton IL 60189

St. Mary Cemetery 1.630.668.3313
Alexander Blvd, Elmhurst IL 60146

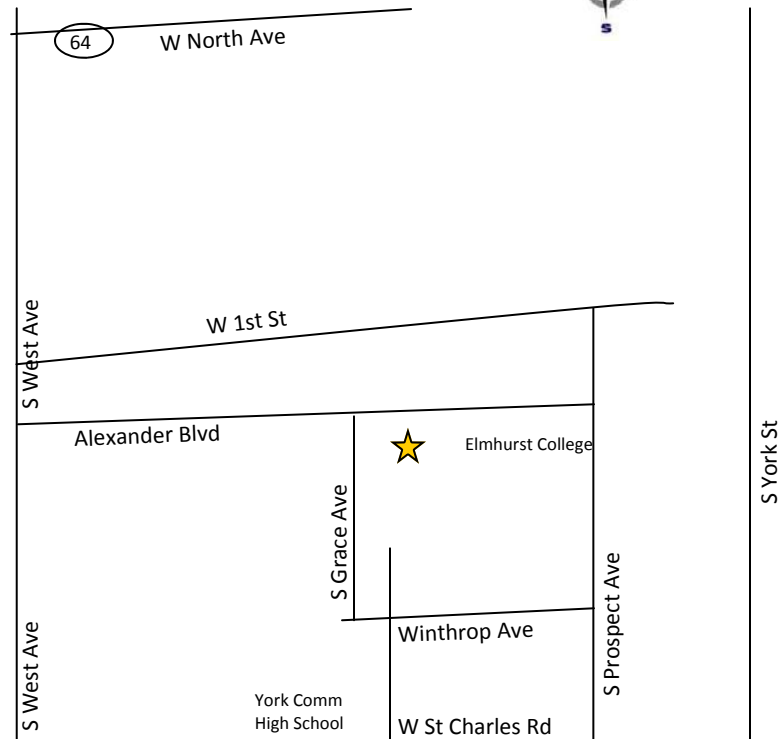

www.dioceseofjoliet.org/cemeteries

for complete details including the wide range of choices and pricing



The Catholic Cemeteries of the Diocese of Joliet

This cemetery is nestled in the community of Winfield offering the following burial services; Private Mausoleum Entombment Crypts, In-ground burial for full body remains and cremated remains, with upright or flush memorial options.

- *Pre-need and At-need burial services tailored to meet your family needs*
- *Private Mausoleum's are entombment options*
- *Mature tree lined burial grounds for in-ground burial with upright or flush memorial*
- *In-ground with upright or flush memorial are cremation options*
- *Personalized and Custom Memorials created and designed reflecting a life loved and lived.*
- *Bench memorials available as a place to sit and reflect which can also be developed to hold the cremated remains of a loved one*
- *Vases are another form of memorialization available to hold the placement of flowers honoring a life*



Family Service Center located at:
Assumption Cemetery
1S.510 Winfield Rd
Wheaton IL 60189

St. John the Baptist Cemetery 1.630.668.3313
Summit & Garys Mill Rd, Winfield IL 60190

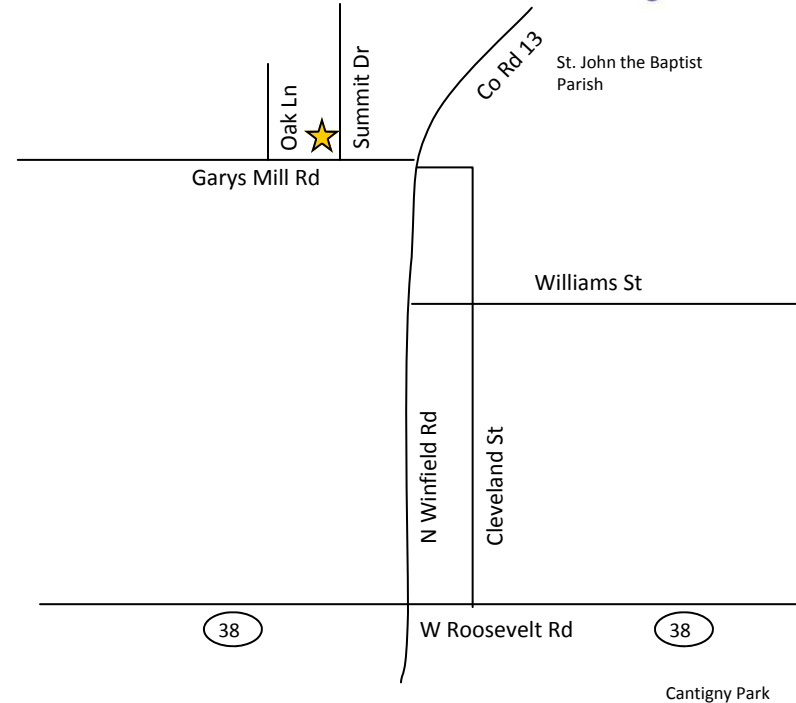

www.dioceseofjoliet.org/cemeteries

for complete details including the wide range of choices and pricing



The Catholic Cemeteries of the Diocese of Joliet

Opened in 2004, this is the newest of our cemeteries. It spreads 80 acres of what was once farmland. A family service center is on-site and offers a chapel for the final committal serve. A large line of burial services are offered; Private Mausoleum Entombment Crypts, In-ground burial, and Cremation options including a specifically designed Cremation Garden, and Garden Niches. It is one of the few cemeteries in the area to offer a Cremation Garden.

- *Pre-need and At-need burial services tailored to meet your family needs*
- *Chapel for final committal service, prayer and reflection*
- *Private Mausoleum's are entombment options*
- *Tree lined burial grounds for in-ground burial with upright or flush memorial*
- *In-ground with upright or flush memorial, Granite Front Cremation Niches, and specifically designed Cremation Gardens are cremation options*
- *Personalized and Custom Memorials created and designed reflecting a life loved and lived.*
- *Bench memorials available as a place to sit and reflect which can also be developed to hold the cremated remains of a loved one*
- *Vases are another form of memorialization available to hold the placement of flowers honoring a life*

Risen Lord Cemetery 1.630.554.7590
1501 Simons Rd/127th St, Oswego IL 60543

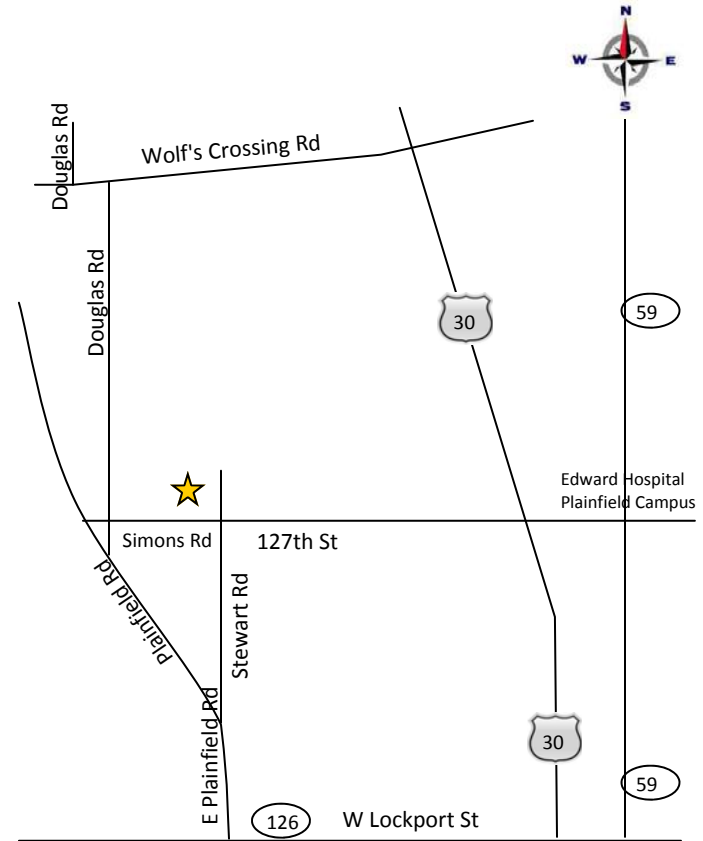

www.dioceseofjoliet.org/cemeteries

for complete details including the wide range of choices and pricing



The Catholic Cemeteries of the Diocese of Joliet

Developed in 1956, this cemetery has an on-site family service center. The first mausoleum was developed in 1972 known as the "Chapel Mausoleum" and holds the entombments of the deceased Diocesan Bishops. This cemetery offers a comprehensive line of burial services; Chapel Mausoleum, Communal and Private Mausoleum Entombment Crypts, In-ground burial, and Cremation options including indoor glass front cremation niches for the cremated remains of the body.

- *Pre-need and At-need burial services tailored to meet your family needs*
- *Chapel Mausoleum for final committal service, prayer and reflection, with lighted devotional votive stand*
- *Private or Communal Mausoleum's are entombment options*
- *Mature tree lined burial grounds for in-ground burial with upright or flush memorial*
- *In-ground with upright or flush memorial, Glass Front, Wood Front, and Granite Front Cremation Niches are cremation options*
- *Special Infant Memorial garden*
- *Personalized and Custom Memorials created and designed reflecting a life loved and lived.*
- *Bench memorials available as a place to sit and reflect which can also be developed to hold the cremated remains of a loved one*
- *Vases are another form of memorialization available to hold the placement of flowers honoring a life*

Resurrection Cemetery 1.815.886.0750
200 W Romeo Rd/135th St
Romeoville IL 60446

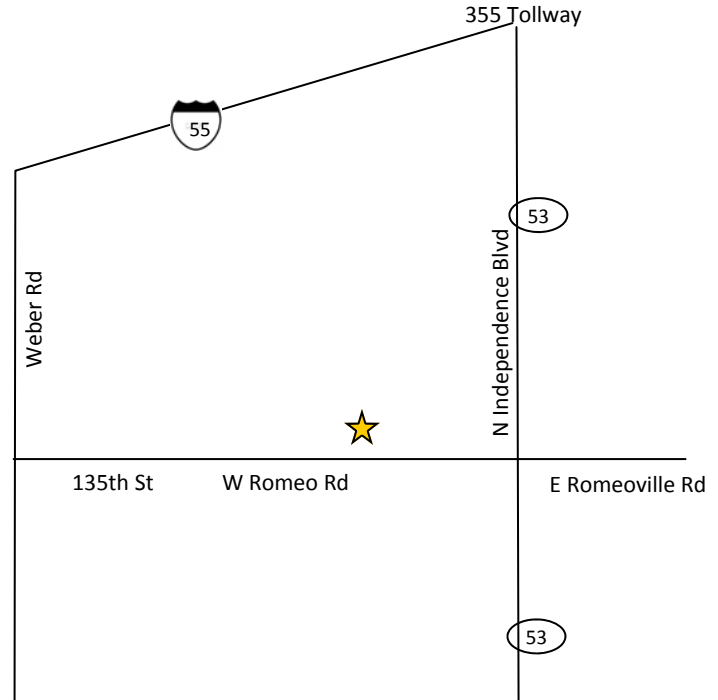

www.dioceseofjoliet.org/cemeteries
for complete details including the wide range of choices and pricing



The Catholic Cemeteries of the Diocese of Joliet

Rich in history with the first burial occurring in 1863. The cemetery has an on-site family service center. They offer: Chapel available for the final committal service, Communal Garden Crypts for Entombment, Private Mausoleum Entombment Crypts, In-ground burial for full body remains and cremated remains, with upright or flush memorial options.

- *Pre-need and At-need burial services tailored to meet your family needs*
- *Chapel available for final committal service, prayer and reflection*
- *Private Mausoleum's or Communal Garden Crypts are entombment options*
- *Mature tree lined burial grounds for in-ground burial with upright or flush memorial*
- *In-ground with upright or flush memorial, are cremation options*
- *Special Infant Memorial garden*
- *Personalized and Custom Memorials created and designed reflecting a life loved and lived.*
- *Bench memorials available as a place to sit and reflect which can also be developed to hold the cremated remains of a loved one*
- *Vases are another form of memorialization available to hold the placement of flowers honoring a life*

Mt. Olivet Cemetery 1.815.726.7444
1320 E Cass St, Joliet IL 60432

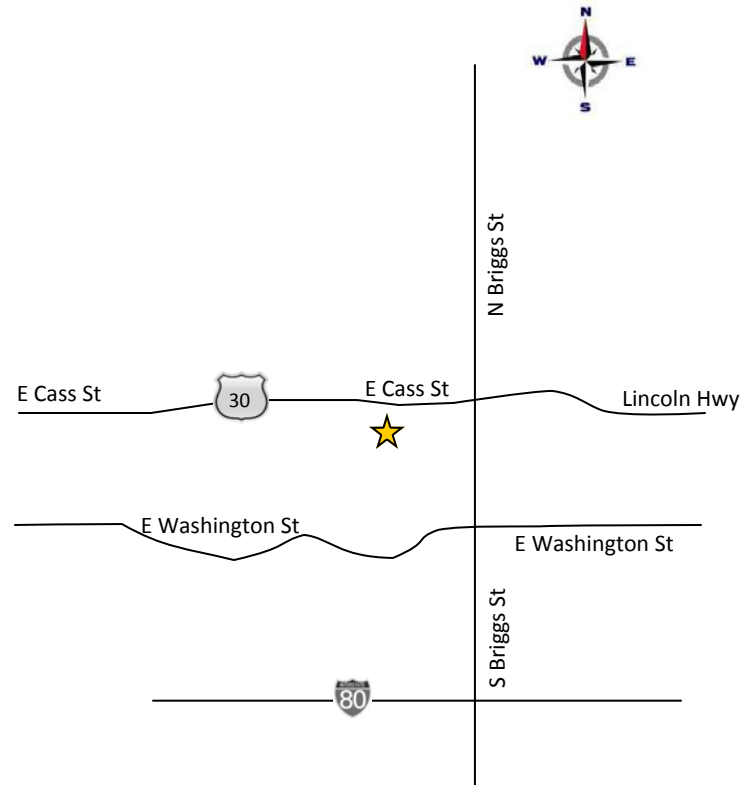

www.dioceseofjoliet.org/cemeteries
for complete details including the wide range of choices and pricing



The Catholic Cemeteries of the Diocese of Joliet

This cemetery is nestled in a tranquil Joliet community offering the following burial services; Chapel Mausoleum, Private Mausoleum Entombment Crypts, In-ground burial for full body remains and cremated remains, with upright or flush memorial options.

- *Pre-need and At-need burial services tailored to meet your family needs*
- *Chapel Mausoleum for final committal service, prayer and reflection*
- *Private Mausoleum's are entombment options*
- *Mature tree lined burial grounds for in-ground burial with upright or flush memorial*
- *In-ground with upright or flush memorial are cremation options*
- *Personalized and Custom Memorials created and designed reflecting a life loved and lived.*
- *Bench memorials available as a place to sit and reflect which can also be developed to hold the cremated remains of a loved one*
- *Vases are another form of memorialization available to hold the placement of flowers honoring a life*



*Family Service Center located at:
Mt. Olivet Cemetery
1320 E. Cass St
Joliet IL 60432*

Ss. Cyril & Methodius Cemetery 1.815.726.7444
Rte 6 / 2001 Maple Rd, Joliet IL 60432

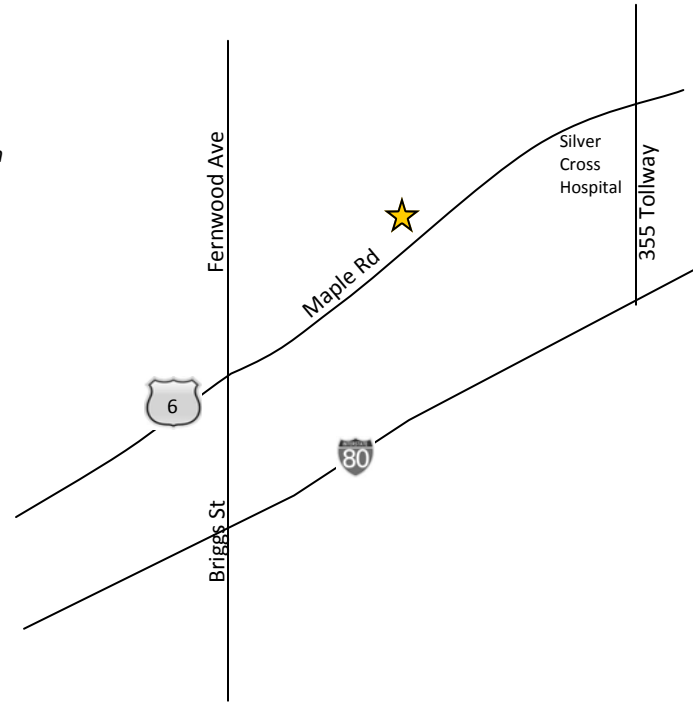

www.dioceseofjoliet.org/cemeteries

for complete details including the wide range of choices and pricing



The Catholic Cemeteries of the Diocese of Joliet

In the Saint Patrick neighborhood, this cemetery has always been a "Diocesan Cemetery" with the first lot sale in December of 1867. Offering the following burial services; Private Mausoleum Entombment Crypts, In-ground burial for full body remains and cremated remains, with upright or flush memorial options.

- *Pre-need and At-need burial services tailored to meet your family needs*
- *Private Mausoleum's are entombment options*
- *Mature tree lined burial grounds for in-ground burial with upright or flush memorial*
- *In-ground with upright or flush memorial are cremation options*
- *Personalized and Custom Memorials created and designed reflecting a life loved and lived.*
- *Bench memorials available as a place to sit and reflect which can also be developed to hold the cremated remains of a loved one*
- *Vases are another form of memorialization available to hold the placement of flowers honoring a life*

Family Service Center located at:
Mt. Olivet Cemetery
1320 E. Cass St
Joliet IL 60432

St. Patrick Cemetery 1.815.726.7444
W Jefferson St & N Hunter Ave
Joliet IL 60435

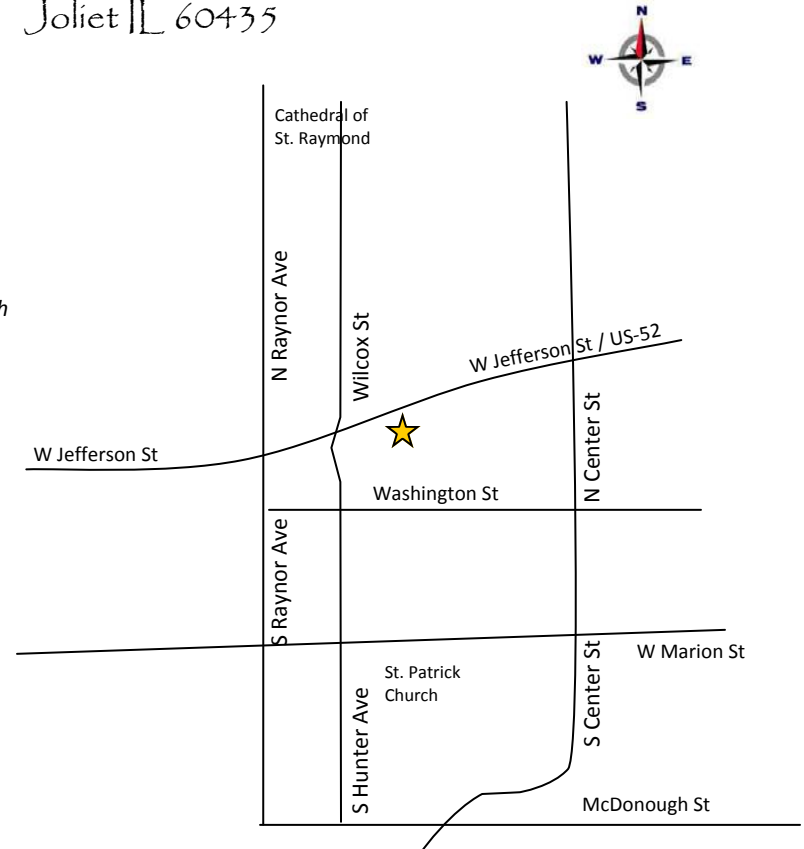

www.dioceseofjoliet.org/cemeteries

for complete details including the wide range of choices and pricing



The Catholic Cemeteries of the Diocese of Joliet

Developed in 1852 with the first burial in 1859.

Offering the following burial services; Private Mausoleum Entombment Crypts, In-ground burial for full body remains and cremated remains, with upright or flush memorial options.

- *Pre-need and At-need burial services tailored to meet your family needs*
- *Private Mausoleum's are entombment options*
- *Mature tree lined burial grounds for in-ground burial with upright or flush memorial*
- *In-ground with upright or flush memorial are cremation options*
- *Personalized and Custom Memorials created and designed reflecting a life loved and lived.*
- *Bench memorials available as a place to sit and reflect which can also be developed to hold the cremated remains of a loved one*
- *Vases are another form of memorialization available to hold the placement of flowers honoring a life*



Family Service Center located at:
Mt. Olivet Cemetery
1320 E. Cass St
Joliet IL 60432

St. John the Baptist Cemetery 1.815.726.7444
Ruby St at Clement, Joliet IL 60435

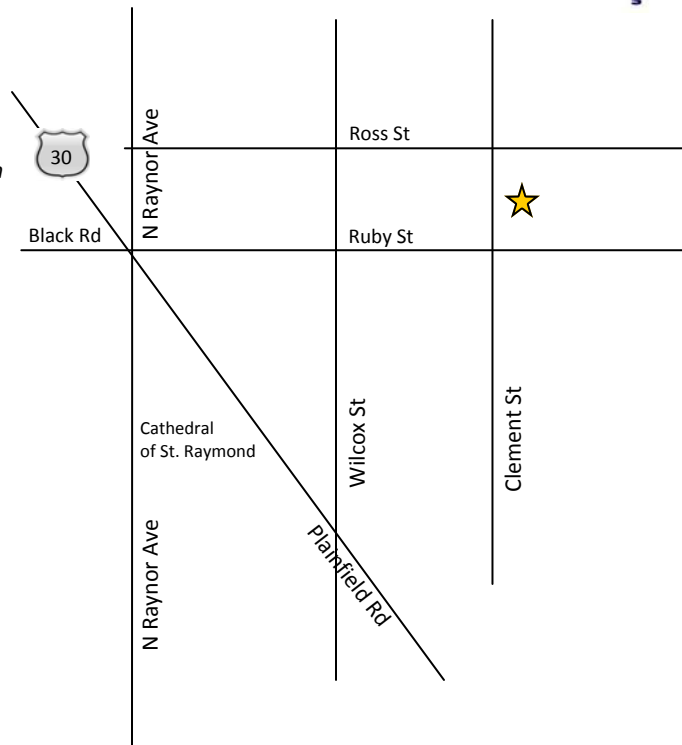

www.dioceseofjoliet.org/cemeteries

for complete details including the wide range of choices and pricing



The Catholic Cemeteries of the Diocese of Joliet

This neighborhood cemetery offers the following burial services;
Private Mausoleum Entombment Crypts, In-ground burial for full
body remains and cremated remains, with upright or flush memorial
options.

- *Pre-need and At-need burial services tailored to meet your family needs*
- *Private Mausoleum's are entombment options*
- *Mature tree lined burial grounds for in-ground burial with upright or flush memorial*
- *In-ground with upright or flush memorial are cremation options*
- *Personalized and Custom Memorials created and designed reflecting a life loved and lived.*
- *Bench memorials available as a place to sit and reflect which can also be developed to hold the cremated remains of a loved one*
- *Vases are another form of memorialization available to hold the placement of flowers honoring a life*



Family Service Center located at:
Mt. Olivet Cemetery
1320 E. Cass St
Joliet IL 60432

Holy Cross Cemetery 1.815.726.7444
Theodore St, Crest Hill IL 60435

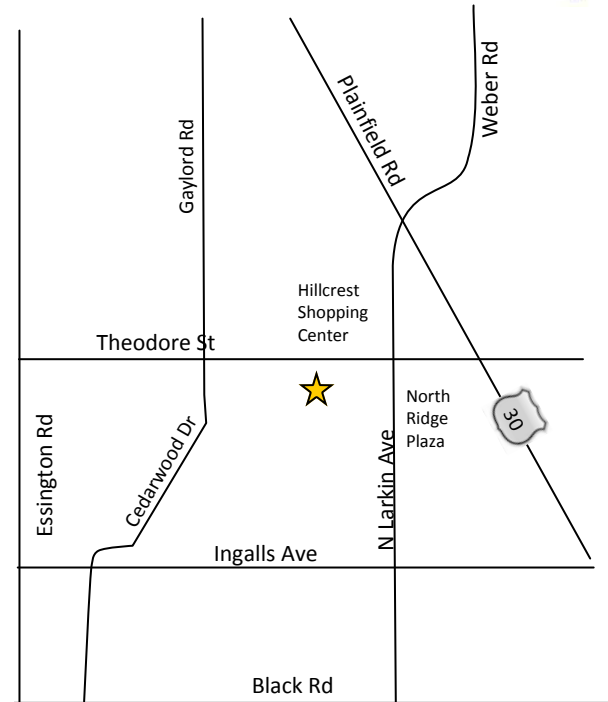

www.dioceseofjoliet.org/cemeteries

for complete details including the wide range of choices and pricing



The Catholic Cemeteries of the Diocese of Joliet

This neighborhood cemetery was developed in 1906 by the local community and later became part of the Joliet Diocesan cemeteries in 1986. It offers the following burial services; Chapel available for the final committal service, Private Mausoleum Entombment Crypts, In-ground burial for full body remains and cremated remains, with upright or flush memorial options.

- *Pre-need and At-need burial services tailored to meet your family needs*
- *Chapel Mausoleum for final committal service, prayer and reflection*
- *Private Mausoleum's are entombment options*
- *Mature tree lined burial grounds for in-ground burial with upright or flush memorial*
- *In-ground with upright or flush memorial are cremation options*
- *Personalized and Custom Memorials created and designed reflecting a life loved and lived.*
- *Bench memorials available as a place to sit and reflect which can also be developed to hold the cremated remains of a loved one*
- *Vases are another form of memorialization available to hold the placement of flowers honoring a life*



*Family Service Center located at:
Mt. Olivet Cemetery
1320 E. Cass St
Joliet IL 60432*

St. Mary Nativity Cemetery 1.815.726.7444
Caton Farm Rd, Crest Hill IL 60435

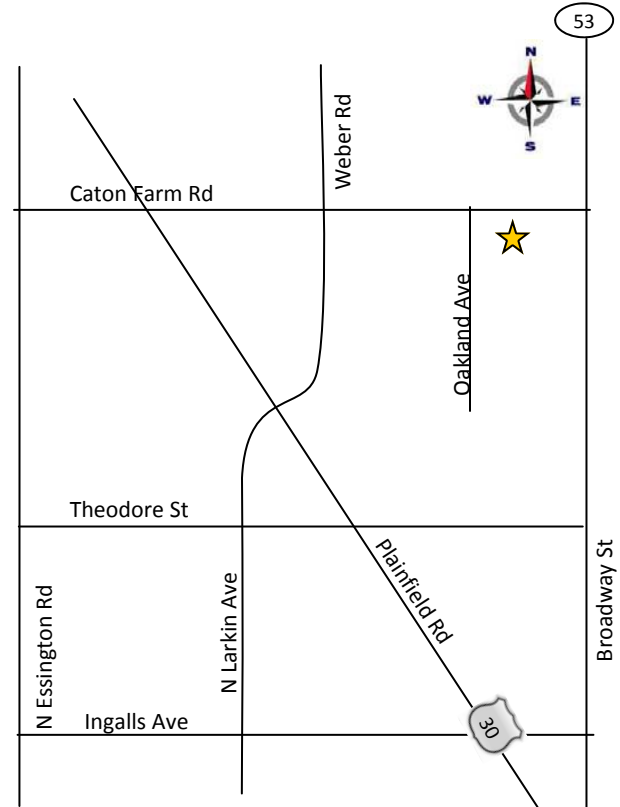

www.dioceseofjoliet.org/cemeteries

for complete details including the wide range of choices and pricing



The Catholic Cemeteries of the Diocese of Joliet

This cemetery offers the following burial services;
Private Mausoleum Entombment Crypts, In-ground burial for full
body remains and cremated remains, with upright or flush memorial
options.

- *Pre-need and At-need burial services tailored to meet your family needs*
- *Private Mausoleum's are entombment options*
- *Mature tree lined burial grounds for in-ground burial with upright or flush memorial*
- *In-ground with upright or flush memorial are cremation options*
- *Personalized and Custom Memorials created and designed reflecting a life loved and lived.*
- *Bench memorials available as a place to sit and reflect which can also be developed to hold the cremated remains of a loved one*
- *Vases are another form of memorialization available to hold the placement of flowers honoring a life*



Family Service Center located at:
Mt. Olivet Cemetery
1320 E. Cass St
Joliet IL 60432

Calvary Cemetery 1.815.726.7444
Rte 171 & High Rd, Lockport IL 60441

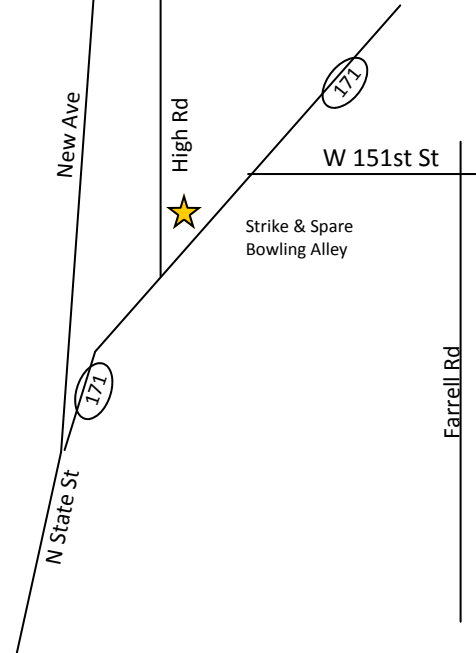

www.dioceseofjoliet.org/cemeteries

for complete details including the wide range of choices and pricing



The Catholic Cemeteries of the Diocese of Joliet

All Saints Cemetery 1.815.933.2342
1839 W State Rte 102, Bourbonnais IL 60914



Tranquil country side surroundings developed in 1964, with a family service center on-site. This cemetery offers a comprehensive line of burial services; Chapel Mausoleum, Communal and Private Mausoleum Entombment Crypts, In-ground burial, and Cremation options including specifically designed Cremation Gardens, Garden Niches, and indoor Mausoleum Niches for cremated remains. It is one of the few cemeteries in the area to offer a Cremation Garden and Glass Front Cremation Niches.

- *Pre-need and At-need burial services tailored to meet your family needs*
- *Chapel Mausoleum for final committal service, prayer and reflection, with lighted devotional votive stand*
- *Private or Communal Mausoleum's are entombment options*
- *Double depth lawn crypts for superior protection from the elements*
- *Mature tree lined burial grounds for in-ground burial with upright or flush memorial*
- *In-ground with upright or flush memorial, Glass Front & Granite Front Cremation Niches, and specifically designed Cremation Gardens are cremation options*
- *Special Infant Memorial garden*
- *Personalized and Custom Memorials created and designed reflecting a life loved and lived.*
- *Bench memorials available as a place to sit and reflect which can also be developed to hold the cremated remains of a loved one*
- *Vases are another form of memorialization available to hold the placement of flowers honoring a life*

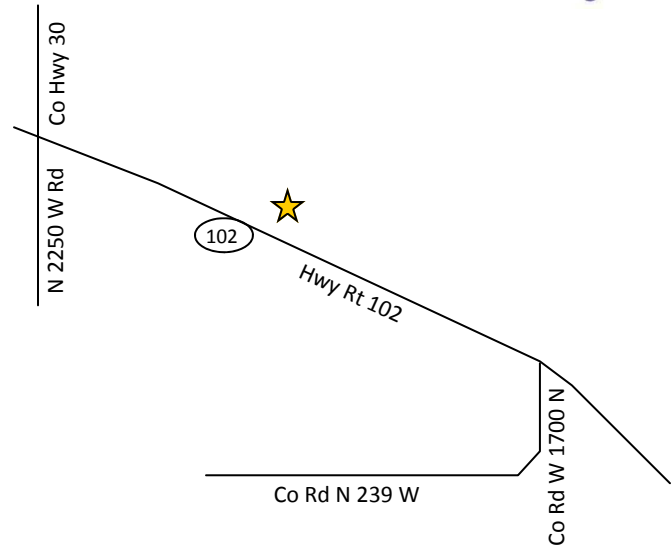

www.dioceseofjoliet.org/cemeteries

for complete details including the wide range of choices and pricing



The Catholic Cemeteries of the Diocese of Joliet

Developed in 1806, with a Mausoleum constructed in 1977. This cemetery offers a comprehensive line of burial services; Chapel Mausoleum, Communal and Private Mausoleum Entombment Crypts, In-ground burial for full body remains and cremated remains, with upright or flush memorial options.

- *Pre-need and At-need burial services tailored to meet your family needs*
- *Chapel Mausoleum for final committal service, prayer and reflection*
- *Private Mausoleum are entombment options*
- *Mature tree lined burial grounds for in-ground burial with upright or flush memorial*
- *In-ground with upright or flush memorial, Granite Front Cremation Niches are cremation options*
- *Personalized and Custom Memorials created and designed reflecting a life loved and lived.*
- *Bench memorials available as a place to sit and reflect which can also be developed to hold the cremated remains of a loved one*
- *Vases are another form of memorialization available to hold the placement of flowers honoring a life*



*Family Service Center located at:
All Saints Cemetery
1839 W. Rte 102
Bourbonnais IL 60914*

Mt. Calvary Cemetery 1.815.933.2342
2000 E Court St, Kankakee IL 60901

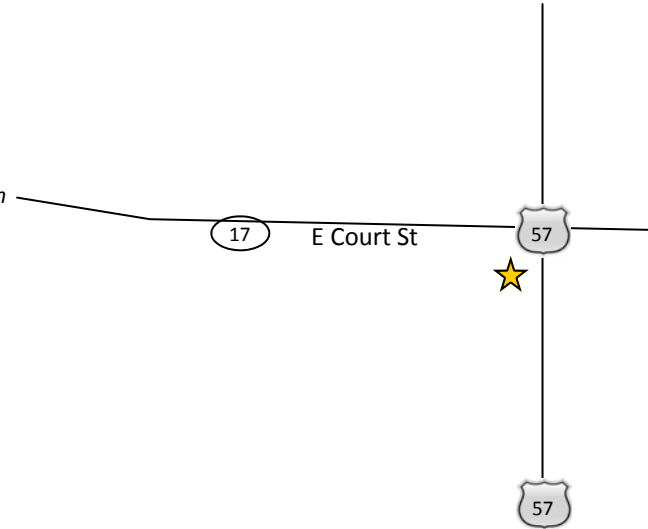

www.dioceseofjoliet.org/cemeteries

for complete details including the wide range of choices and pricing



The Catholic Cemeteries of the Diocese of Joliet

This cemetery offers Private Mausoleum Entombment Crypts,
In-ground burial for full body remains and cremated remains, with
upright or flush memorial options.

- *Pre-need and At-need burial services tailored to meet your family needs*
- *Private Mausoleum are entombment options*
- *Mature tree lined burial grounds for in-ground burial with upright or flush memorial*
- *In-ground with upright or flush memorial are cremation options*
- *Personalized and Custom Memorials created and designed reflecting a life loved and lived.*
- *Bench memorials available as a place to sit and reflect which can also be developed to hold the cremated remains of a loved one*
- *Vases are another form of memorialization available to hold the placement of flowers honoring a life*

*Family Service Center located at:
All Saints Cemetery
1839 W. Rte 102
Bourbonnais IL 60914*

Maternity BVM Cemetery 1.815.933.2342
Canterbury Ln, Bourbonnais IL 60914

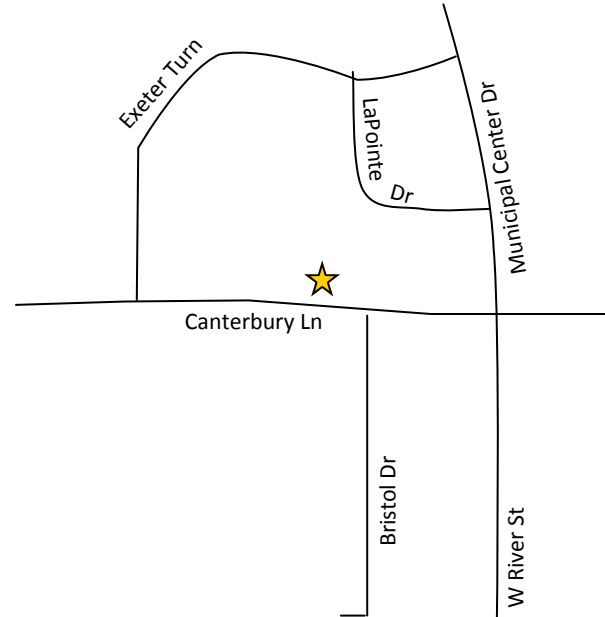

www.dioceseofjoliet.org/cemeteries

for complete details including the wide range of choices and pricing